

# INSTRUCTIONS

## Setting Up :

- 1 Use one of the two included keys to unlock the tent.

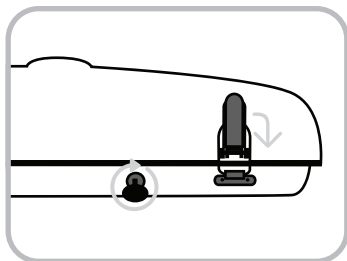

- 2 Release the two toggle latches.

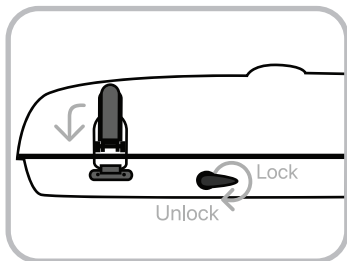

- 3 Unlock the gas springs by rotating the rotary knob.

- 4 Lightly push the tent up. It will open up on its own after the first centimeters.

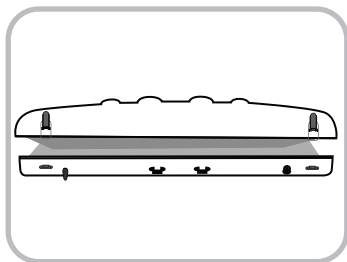

- 5 Take the ladder out of the textile bag, located under the mattress. Attach its hooks on the metal loops, and lower it down to the ground. Make sure it steps securely, and that the load is carried by the ground, and the ladder is not hanging on the metal hooks.

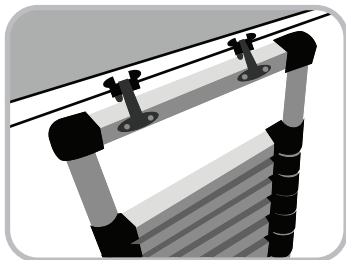

- 6 You are ready to sleep!

## Closing:

- 1 Close the ventilation pockets and the side doors completely, including all the layers. We recommend leaving the back door partially or completely open. Take the closing strap out of the pocket.

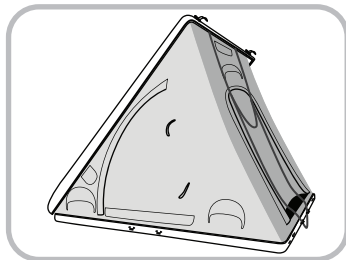

- 2 Fold the telescopic ladder and store it in the textile bag.



- 3 Pull the tent down using the closing strap. Don't close the tent completely, leave it about 20cm opened, and use the rotary knob to lock the gas springs.

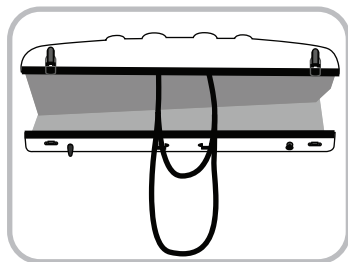

- 4 Fold all the fabric inside above the closing mechanism, and put the closing strap back into its pocket.

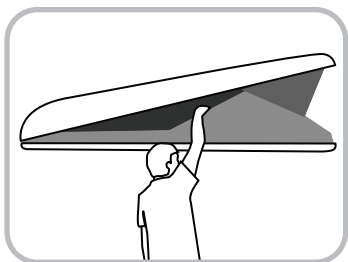

- 5 Unlock the gas springs, and close the tent completely.

6 Close the toggle latches one by one, with one hand, while **pressing the roof down with the other hand, assisting the toggle latches.**

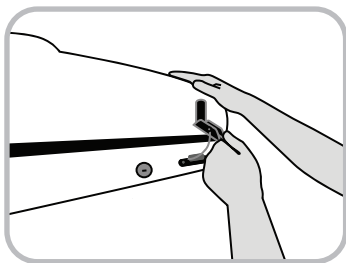

7 Lock the gas springs.

8 Use the key to lock the tent if you would like to.

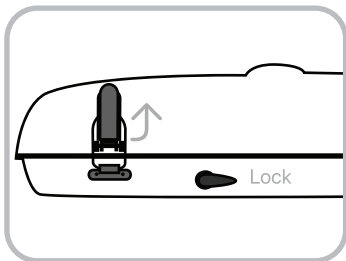

9 You are ready to go!

## Attaching to a car:

The following technical drawing describes how the tent is attached to a car. You can use this dimensions to measure how the tent will look on your car.

In order to mount the tent on a car you need to install two roof bars at least 135cm long. And maximum 9cm wide. If they are higher than 4cm you will need to request from us custom mounting screws.

The minimum distance between the two roof bars must be at least 1m.

- 1 Put the tent on the roof bars of your car. This can be easily done by two adult men.
- 2 Release the toggle latches and unlock the gas springs.
- 3 Lightly open the tent (30 cm is enough), and lock the gas springs. Pay attention that you do not let the tent to open up completely, because in windy weather it may fall off from your car! The tent is equipped with 4 mounting brackets, with 2 hand grip screws each.

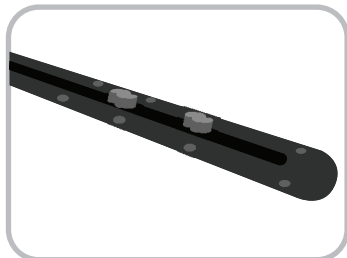
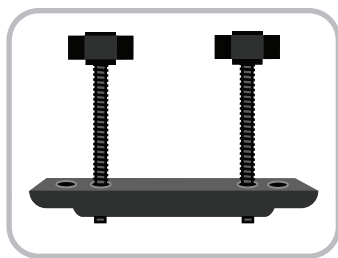
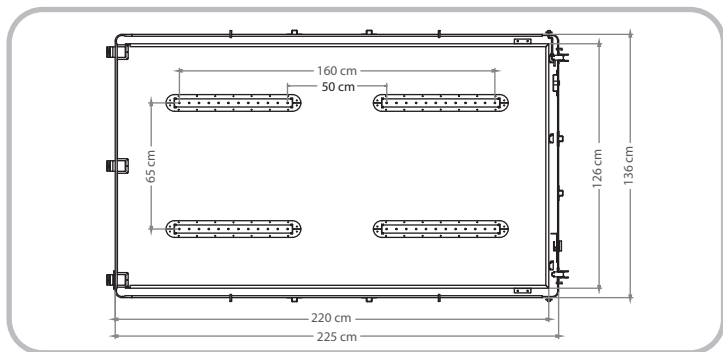

4 Open up the side doors and insert the two hand grip screws through the holes on the bottom, so that the roof bar lies between them. Do this for all the four ends of the two roof bars.

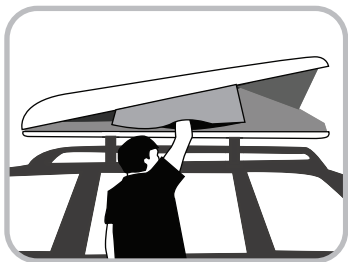

5 Walk around your car and make sure that the tent is precisely centered.

6 Get the mounting brackets and attach them by turning the hand grip screws.

7 Make sure everything is securely tightened up, including the roof bars of the car! The mounting bracket must be horizontal, and parallel to the surface of the roof bar, making as much contact as possible, not just touching on a corner. It's advisable to verify that the tent is properly mounted after driving a short distance after mounting the tent.

**Attaching the tent to the car is entirely your responsibility. We do not take any responsibility of improper mounting!**

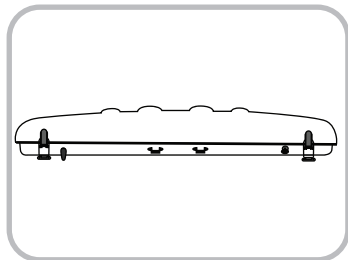

8 Unlock the gas springs, and close the tent completely.

## Features:

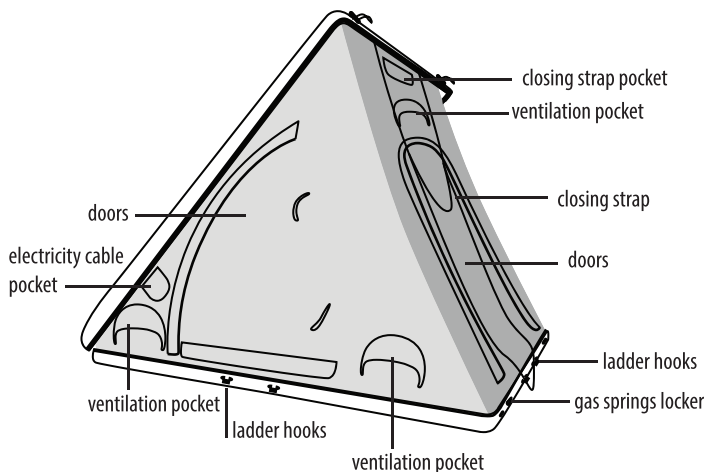

### ● Ventilation pockets:

Vagabond Home is equipped with 5 ventilation pockets. Two in the bottom of each side and one over the back door. They are intended to support ventilation between the inner and outer layer of fabric, and so prevent condensation and decrease temperature in hot weather. You can close them when the weather is cold, this will increase the internal temperature. They should be opened in high moisture and rainy weather to prevent condensation.



## ● Doors

The Vagabond Home has three doors – one on the back and one on each side. The door consists of the following – an anti-mosquito mesh door with fabric cover on the inner layer, and a door on the outer. The outer back door can be opened on each side, for your convenience. Opening it top down can provide you with increased privacy, while being in the tent. For your convenience the doors are designed in such a way, that it's not needed to open the mesh door and fabric cover separately to exit or enter the tent. The fabric cover is attached to the mesh door, so opening the door's zipper opens the cover automatically.

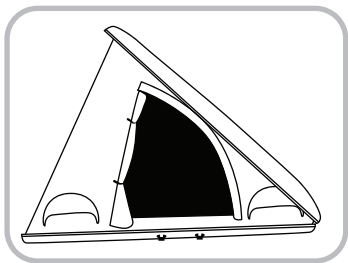
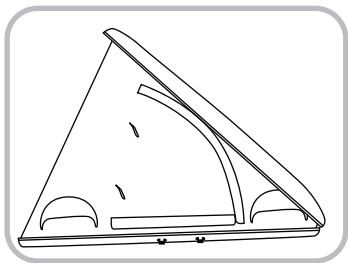

## ● Lightning and power socket:

The Vagabond Home is equipped with four points lightning. The upper two lights are intended for general lightning, while the lower two are intended mainly for reading. They can be dimmed separately by the two rotary knobs, located on the control panel. Right next to them is located the on/off switch for turning the lightning on and off. The power socket is an automotive ISO 4165 Cigarette Lighter Receptacle, large size

(21mm). It is intended for charging portable electronics and is constantly powered on. To power the Vagabond Home you have to take the electrical cable out of the pocket, located on the left side of the tent, and plug it in the lighter socket of the car. The connector fits both ISO 4165 large and small sockets. that it's not needed to open the mesh door and fabric cover separately to exit or enter the tent. The fabric cover is attached to the mesh door, so opening the door's zipper opens the cover automatically.

The maximal consumption of the LED lightning is 12W. The maximal allowed current draw from the power socket is 6A. The safety fuse size is 8A and is located in the power plug. Do not replace the safety fuse with a larger one!

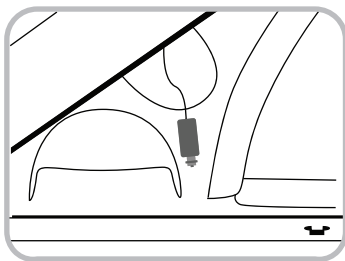

#### ● Ladder:

The Vagabond Home is equipped with a high quality telescopic ladder. It is stored in a textile bag under the mattress.

To unfold the ladder you should simply attach its hooks on the metal loops, release the Velcro loop, and lower it down to the ground. Make sure that the ladder is fully extended, or that all of the stages, that are not fully extended, are located on the top. When the ladder is extended properly it is auto-locked. Before using the ladder make sure that it is “firmly stepped” on the ground, and that most of the weight is supported by the ground,

and not by the metal loops.

The ladder must be used properly and with caution. We do not take responsibility of any personal injury or material damage while using the ladder.

To collapse the ladder detach it from the metal loops and press the two pins located on each step one by one, and assist its closing with hand. Then you have to attach the holding Velcro loop and now it can be stored in the textile bag. It prevents the mattress and other valuables from being contaminated by the dirt that the ladder picks up, due to its normal use.

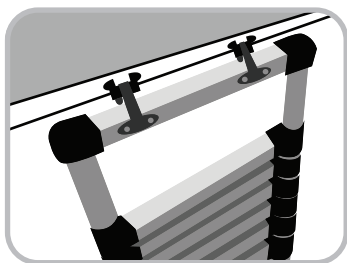

#### ● Detachable fabrics

The two layers of fabric are completely detachable. This is convenient for washing or repairing some sort of accidental damage.

Never use a washing machine or similar way to wash the outer fabric. Washing it only with a wet towel is recommended. The inner layer can be washed at 30 degree synthetics cycle, with a non-aggressive detergent.

However washing it frequently is not recommended.

To detach one of the layers of fabric simply start from one of the front corners continue gently pulling back and then towards the other one.

To attach it back, start from the rear bottom line of Velcro, and use all of the bottom lines and the four corners of the rear side as guidelines. For your convenience you can slightly collapse the tent by 5-10 cm. Pay attention that the first times when you attach the fabrics to the tent, it will take some time, especially if the tent is on top of the car.

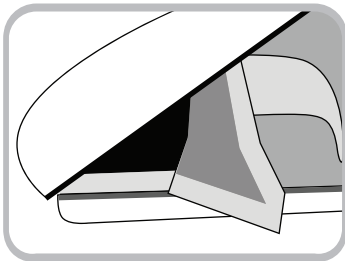

#### ● Pockets

The tent is equipped with 4 pockets – two on each side. The front ones are intended for storing personal electronics, small books, keys, wallets and others, while the rear ones are usually used as a cup holder.

